

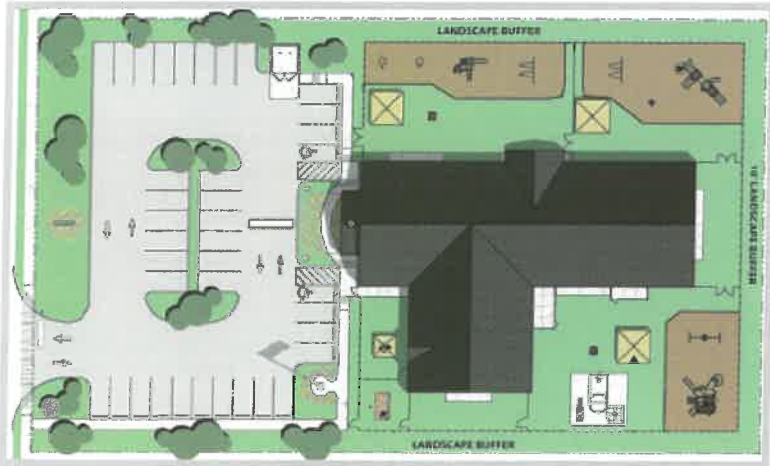

# SUBURBAN LOCATIONS



Prototypical Site Plan  
60,000 sf site, 12,000 sf building



## PRIMROSE SCHOOL SITE CRITERIA

All opportunities considered including:

- Purchase of separate parcel for ground-up construction (preferred)
- Purchase or lease of freestanding single-user building for conversion
- Lease of space in multi-tenant property

Property Requirements:

- 40,000 sq. ft. minimum (ground up construction)
- 8,000 – 15,000 sq. ft. building/space
- 5,000 sq. ft. outdoor play area
- Parking as required by code
- Safe & convenient access

Demographic Criteria:

- Strong upper-middle income levels
- 2,000 children 0-4 years old within 3 miles



PrimroseSchools.com • 800.PRIMROSE (800.774.6767)

The Leader in Early Education anCare®



# SUBURBAN LOCATIONS



Westlake-Entrada



Typical Playground



Typical Suburban Interior Finish



Atlanta - Sandy Springs South



Charlotte-Huntersville

## Site Acquisition Managers

**BOB ROSSMAN** 603.770.9868 BRossman@PrimroseSchools.com  
CT, DE, MA, MD, ME, NH, NJ, NY, PA, RI, VA, VT, WV

**MIKE SCHECKEL** 678.778.2916 MScheckel@PrimroseSchools.com  
IL, IN, KY, MI, MN, NC, OH, SC, TN, WI

**TIM GODSEY** 480.270.9148 TGodsey@PrimroseSchools.com  
AZ, CA, CO, IA, ID, KS, MO, MT, ND, NE, NM, NV, OR, SD, UT, WA, WY

**TRAVIS WALDROP** 770.294.6852 TWaldrop@PrimroseSchools.com  
AL, AR, FL, GA, LA, MS, OK, TX

Primrose Schools®, The Leader in Early Education and Care®, is seeking locations in major markets.

Founded in 1982, Primrose Schools is the nation's leader in providing a premier educational child care experience in more than 375 schools in 29 states. Each Primrose school is independently owned and operated by Franchise Owners, who partner with parents to help children build the right foundation for future learning and life. Our exclusive time-tested Balanced Learning® approach balances purposeful play with nurturing guidance from teachers to encourage curiosity, creativity, confidence and compassion. We believe who a child becomes is as important as what they know. For more information, visit [www.PrimroseSchoolsRealEstate.com](http://www.PrimroseSchoolsRealEstate.com)

[PrimroseSchools.com](http://PrimroseSchools.com)

**800.PRIMROSE (800.774.6767)**

The Leader in Early Education and Care®